

RESOLUX 103

Technical Data

The energy saving lights of this series which are already successfully introduced to the market are now substantially improved by a newly developed PCB. The entire control is now built by SMD-technology and powerful filters are used to lower interference and increase the safety of operation. The flicker-free softstart controlled by electronics enlarges the switching frequency rate. Improved electronic parts decrease losses and increase the durability of PC-board and compact lamp. The intelligent PC-board detects critical operational conditions and will switch off the compact lamp if necessary. The compact lamp will operate at its optimum by automatic control. A constant luminous energy during minimum to maximum operating voltage, as well as undervoltage, secures long durability for the compact lamp. The low-loss polarity reversal protection also is a new addition. All luminaires can be used at high switching frequency rates as well as long operation times. The durability of the compact lamp is about 8000 h. All luminaires are built according to CE-certification. A high radio interference suppression according to VDE 087B is standard. This is more than required by CE-Certification. The ground sheet is made of aluminium and is white powder-coated. The prismatic cover is made of temperature- and UV-resistant PC.

Due to these improvements our tradition of high-grade products continues, which guarantees reliability as well as quality.

Daten:

Voltage range 12 Volt:	10,5 Volt bis 15,0 Volt DC
Voltage range 24 Volt:	21,0 Volt bis 29,0 Volt DC
Operating frequency:	33kHz
Crestfactor:	<1,48
Heat time:	ca. 2sek.
Heat frequency:	ca. 52kHz
open circuit power consumption:	< 100 mA
power consumption after turn off:	< 10 mA

Skizze Resolux 103:

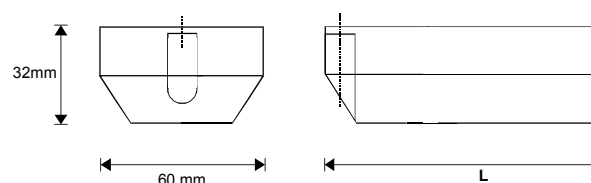

Standard version:	Resolux, Best.-Nr. 10312-1N0 switch and compact lamp light colour 827.
Version without switch:	Resolux, Best.-Nr. 10312-0N0 without switch with compact lamp light colour 827.
Standard light colour 840 (white):	Resolux, Best.-Nr. 10312-1N084 switch and compact lamp light colour 840 (white).

Further comfort additions:

H "half-light" switching HLS. The Resolux 103 with a toggle switch can be switched to 50% light yield and power reduction.

e.g.: 10312-1NH

P pearl integration. Opal diffuser lose 30% of their light transmission. The chemical industry developed a system to inject microscopically small PMMA pearls into the diffuser moulding compound to diffuse light. With 12% pearl concentration a comfortable diffusion has been reached. The loss of light is 14% and therefore as good as colourless diffusers. Using the P-diffusers will reduce the dazzling by direct light remarkably.

e.g.: 10312-1N0P

Order No	Volt	Watt	Length	Current consumption	Comparable incandescent bulb
10312-1N0	12	11	314 mm	1030 mA	75 Watt
10324-1N0	24	11	314 mm	520 mA	75 Watt
10312-1NH	12	11	314 mm	1030 mA	75 Watt
10324-1NH	24	11	314 mm	520 mA	75 Watt
10312-1N0P	12	11	314 mm	1030 mA	75 Watt
10324-1N0P	24	11	314 mm	520 mA	75 Watt